

PUTCO®

MOLLE PANELS

- MODULAR LIGHTWEIGHT LOAD CARRYING EQUIPMENT -

INSTRUCTION GUIDE

FORD RANGER

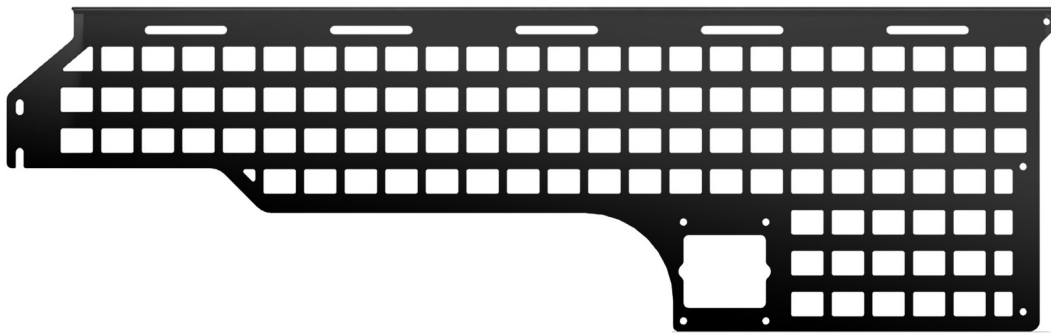

SIDE PANEL

Congratulations on your purchase of a high quality PUTCO® product. Should you need any application or technical assistance, feel free to call us at:

1-800-247-3974

Monday-Friday 8:00am - 5:00pm (Central Standard Time)
Contact your PUTCO® dealer for other quality accessories.



**PLEASE READ ALL INSTRUCTIONS BEFORE INSTALLATION
AND CHECK TO SEE THAT ALL PARTS ARE INCLUDED**

REQUIRED TOOLS

3/16" HEX KEY



5MM HEX KEY



T30 & T40 TORX DRIVER



CONTENT LIST

DESCRIPTION	QTY
Molle Side Plate	1
Middle Bracket	1
Rear Bracket	1
M6 Bolts - 20mm Long - T30 Torx Head Drive	6
M8 Bolts - 25mm Long - 5mm Allen Head Drive	4
5/16-18 Bolt - 2-3/8" Long - 3/16" Allen Hd Drive	1
Well Nut - 5/8" Outer Diameter	1
Spacer - 1-5/8" Long	1



INSTALLATION INSTRUCTIONS

- 1** Begin by unscrewing and removing all factory removable tie-down hooks using a T40 Torx driver. Set these aside, as they will be re-used. Most Ford Ranger beds come equipped with four tie-downs in total.



- 2** The Rear Bracket (shown on the next page) installs behind the rear tie-down (closest to the tailgate). Place the Rear Bracket in between the bed and the rear tie-down, then fasten in place re-using factory hardware. If your Ranger does not have a tie-down in this location, fasten the Rear Bracket using the provided M8 Bolts. Note these Rear Brackets are different depending on whether they attach to the driver's side or the passenger side.
- 3** Install the Middle Bracket in the same manner, either installing it behind factory tie-down or fastening using the provided M8 bolts. Once all brackets are in place, your Ford Ranger bed should look like the picture below.

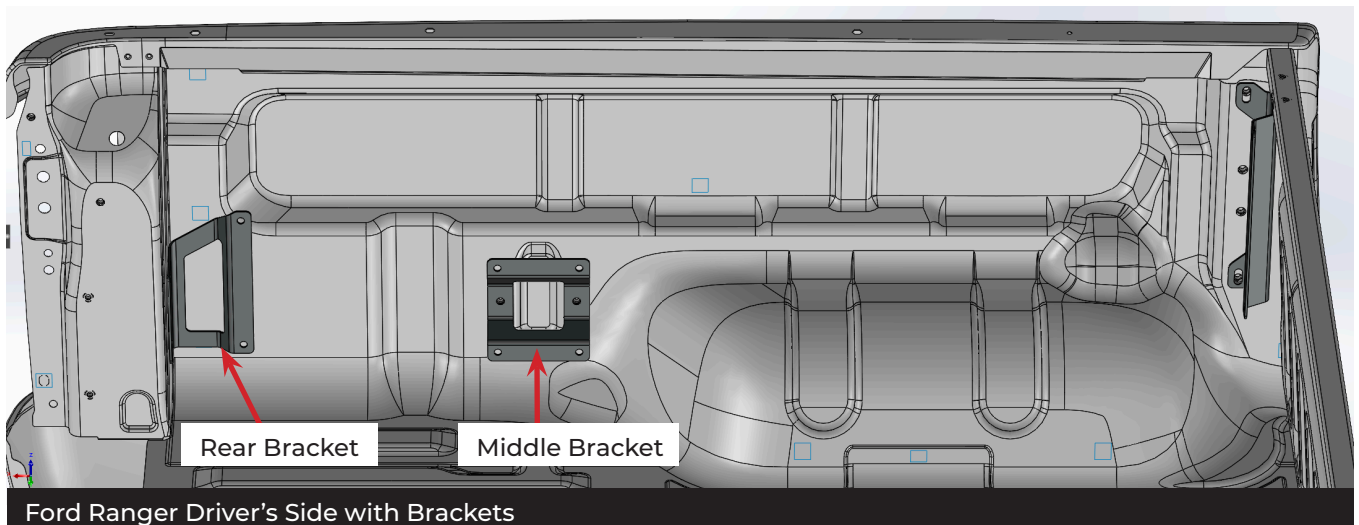

- 4** Fasten the side plate to its brackets using the supplied M6 bolts and a T30 Torx driver.
- 5** The front part of each molle side plate is fastened to the bed in the same manner as the brackets, either behind an existing tie-down, or using the provided M8 bolts.



- 6** For additional stiffness, locate the blank hole located towards to top rear corner of each molle side plate. This hole should line up with a hole in the bed of your Ford Ranger. Insert the provided rubber well nut into this hole, place the aluminum spacer between the well nut and the side plate, then insert the 2-3/8" long bolt through the plate and spacer, and thread it into the well nut. See the picture on the next page. Tighten the bolt using a 3/16" hex key until the well nut is snug in the hole, but do not overtighten!

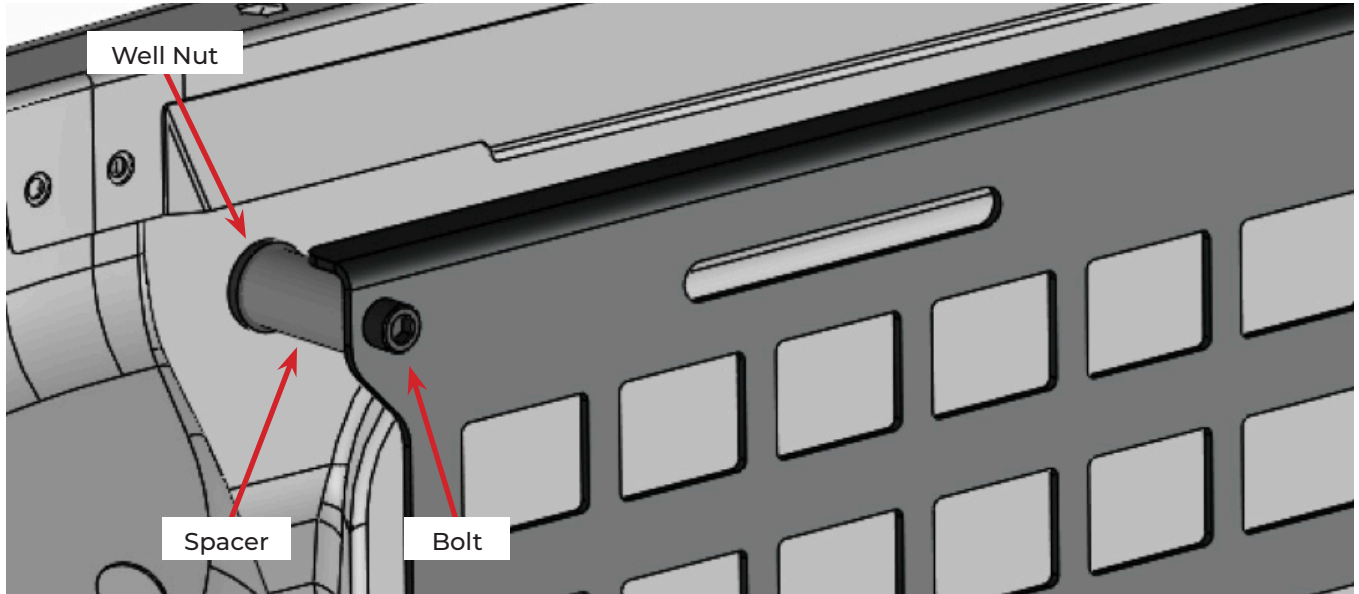

- 7** Once the side plate is installed in the vehicle, ensure all fasteners are tightened until snug, but do not overtighten.

